



GlobalTek™ Heat Tunnel For Heat-Shrink Sleeves Neck Band.

The GlobalTek™ stainless steel construction heat tunnel is manufactured to meet highest standards for the pharmaceutical, food/beverage and many more industries. Our heat tunnel is precisely designed to ‘heat shrink’ shrinkable film wrapped around your package and it is also suitable to shrink a shrinkable neck band or body sleeve around a container.

Bottles must be transported through the heat tunnel with a compatible conveyor (not included) at a consistent and applicable speed. The heating chamber is enclosed by tight-seal brush bristles and a silicone coated fiberglass heat trapping curtain to ensure an even and consistent shrink rate. The heating nozzles may be rotated in any direction to suit your needs.

MACHINE SPECIFICATIONS

Model	TUN-1019
Chamber Size	Width: 10"
	Height: 19"
	Length: 36"
Volts	230
Amperage	55
Phase	Single
Weight	645 lbs
Overall dims	36" x 26" x 22"

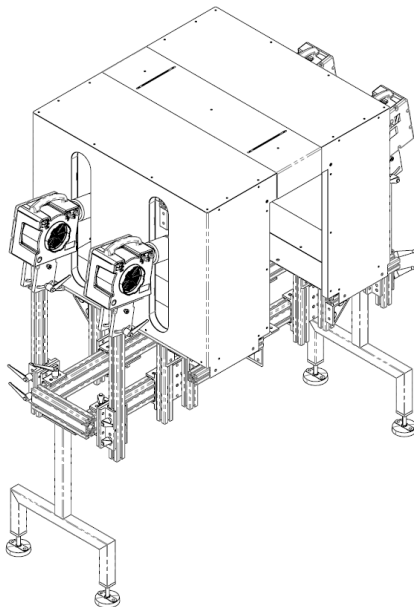

WARNING! Only authorized or trained personnel should operate the Heat Tunnel.

Do not tamper with electrical wiring. Always switch off machine and disconnect power before maintenance, cleaning or repairs.

Keep hands away from moving conveyors and other moving parts.

DO NOT operate this machine without all covers and guards in place. Severe injury may result.

Heat-sealing nozzles and parts become hot after a period of use. Keep hands away while machine is in operation.

Do not modify this machine in any way. Modifying the machine will void any warranties.

Some plastic films used for sealing and shrinking may release hazardous fumes at high temperatures. Provide adequate ventilation at all times,

Unplug the Heat Tunnel when not in issue.



IMPORTANT! Read this manual carefully to familiarize yourself with the controls and operation. Keep in safe place for future reference.

OPERATOR CONTROLS

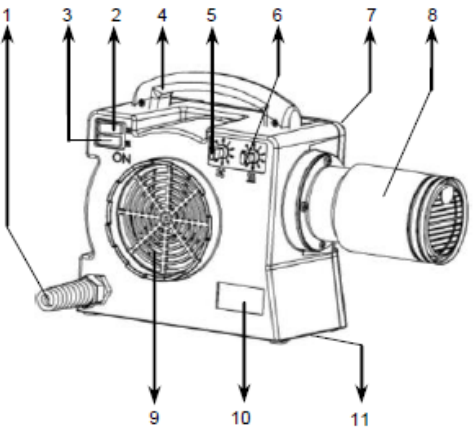
	<ol style="list-style-type: none"> 1. Power supply cord 2. Blower ON – OFF 3. Heater ON – OFF 4. Removable handle 5. Potentiometer for air volume control 6. Potentiometer for temperature control 7. Type plate (back side of the device) 8. Heating element tube 9. Air intake 10. Installation regulator (optional) 11. Six M5 drilled and tapped holes for fixing into installation (Dimensions on the underside of the device)
---	--



Main Power
OFF/ON

●

Master Power
OFF/ON

●

Zone 1
OFF/ON

●

Zone 2
OFF/ON

●

Zone 3
OFF/ON

●

Zone 4
OFF/ON

●

BASIC OPERATION

- 1- Adjust 360 degrees nozzles located in the interior of the tunnel to your desired position depending on the container being used.
- 2- Turn on MASTER POWER switch to ON. This starts machine control panel.
- 3- Turn on MAIN POWER switch to ON. This starts the zones control.
- 4- Turn on each zone as needed. Each zone is controlled individually.
 - a. Heater and blower are controlled separately.
 - b. First turn on the blower, then turn on the heater, until desired temperature range is achieved.

CAUTION! Prior to turning the tunnel on ensure the conveyor is on and running at desired speed.

REPLACEMENT PARTS

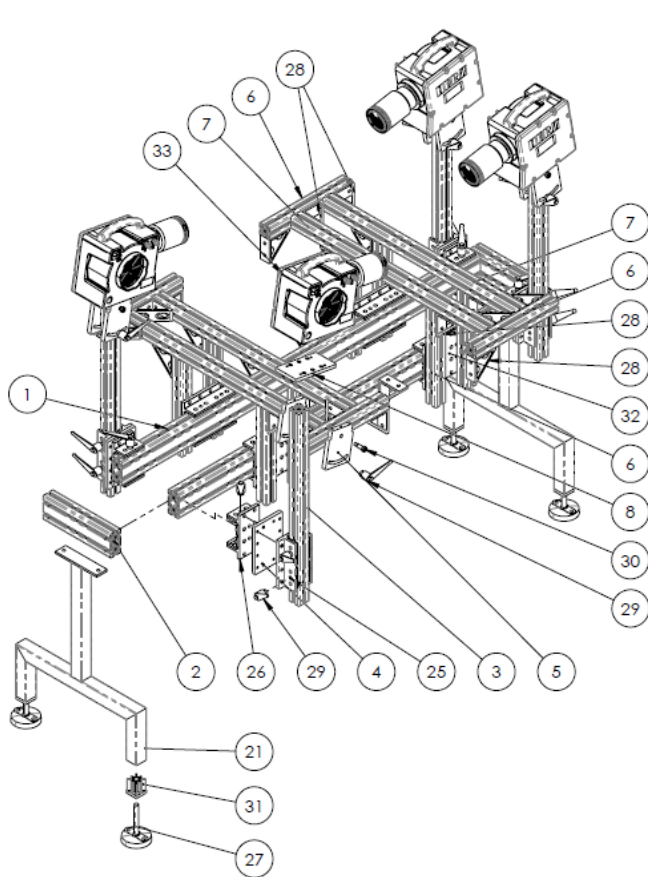

ASSEMBLY BILL OF MATERIALS			
ITEM	QTY.	PartNo	Description
1	2	HT-001-01	SUPPORT BEAM
2	3	HT-001-02	CROSS BAR
3	4	HT-001-04	VERTICAL SUPPORT
4	4	HT-001-05	CONNECT PLATE
5	8	HT-001-06	SWIVEL PLATE
6	12	HT-001-07	TUNNEL SUPPORT BAR
7	4	HT-001-08	TUNNEL CROSS BAR
8	4	HT-001-09	BLOWER BASE
9	2	HT-001-10	OUTSIDE COVER
10	2	HT-001-11 A	INSIDE COVER
11	1	HT-001-12	TOP CENTER COVER
12	1	HT-001-13 A	BOTTOM CENTER COVER
13	2	HT-001-14	BOTTOM SLIDE COVER
14	2	HT-001-15	BOTTOM COVER
15	6	HT-001-16	BOTTOM SPACER
16	4	HT-001-17	SIDE SPACER
17	4	HT-001-18	SHORT SPACER
18	3	HT-001-19	CENTER SPACER
19	4	HT-001-20	SHORT BOTTOM SPACER
20	4	HT-001-23	SHORT TOP SPACER
21	2	HT-001-24	SUPPORT LEG
22	2	HT-001-25	TOP COVER
23	4	HT-001-26	SLOT COVER
24	2	HT-001-27	TOP INNER COVER
25	4	6526 DBL LIN BRG 1515	80/20 DBL FLANGE BRG BRAKE KIT READY
26	4	6523	DOUBLE BEARING 15 S
27	4	2182	
28	24	CORNER GUSSET 4 HOLE	BRACKET
29	20	ZCL-3031	LOCK HANDLE 5/16-18
30	8	3/8X3/4SHOULDER	SHOULDER BOLT
31	4	60945K220	THREADED TUBE INSERT
32	4	8020 6524	DOUBLE LINEAR BEARING
33	4		BLOWER

© 2014 Globaltek Equipment, Inc. All rights reserved. Globaltek Equipment, Inc. is a registered trademark of Globaltek Equipment, Inc. in the United States and other countries.

PROJECT